

# RELAC newsletter

Celebrating 50 Years of Dedicated Service to L.A. County Retirees

May/June 2010 Vol 45-3

## President's Message

by Greg Walia



The most important message I can convey to you in this Newsletter is about the upcoming RELAC election of five members of the Board of Directors to serve three-year terms starting this coming January. Details of the election process are outlined on page 10 of this issue of the Newsletter. Volunteering to serve on the RELAC Board or any of its several committees is a great way to serve your fellow retirees. Please do consider and let us know if you are interested.

### Members Needed

As in past years, RELAC Board members devoted a whole day in February to planning for the coming year. While we look forward to further exploring the feasibility of some of the great ideas presented -- including the establishment of a RELAC Scholarship fund --our focus on that day seemed to center around recruiting new members. While we have identified a number of strategies we think can help us in this regard -- the best effort can be made by our members. Please help us by getting the word out about RELAC membership. Mention us to your recently retired colleagues and contact us for membership recruitment packages. You are our best ambassadors!

### Successful General Membership Meeting

Tuesday, March 23, 2010 will be recorded in RELAC history as one of our best attended General Membership Meetings which was held at the Arboretum in Arcadia, California. Two hundred and seventy members attended this meeting. It was also the date the Health Care Reform bill became the law of the land. While my esteemed colleagues on RELAC Board had the Arcadia meeting date planned months ahead, those folks in D.C. just happened to pick the same date for signing of the bill...a coincidence that added excitement to the event. But credit for planning and arranging the Arcadia meeting goes specifically to members of our Program Committee chaired by Board Member George Hernandez. A job well done, and a big thank you.

Invited guests who participated in the discussion on Health Care Reform included: Brian Mejia, Deputy to Supervisor Michael Antonovich, Robert Hill, Assistant Executive Officer, LACERA, and Gerardo Pinedo, Director, Government Relations and Policy, Los Angeles County Department of Health Services. On behalf of Supervisor Antonovich, Mr. Mejia presented scrolls to retired Board members John Fleming, Fred Miller and Sol Fingold (in absentia), and to RELAC for their outstanding service to retirees. Both Messrs. Hill and Pinedo highlighted summary provisions of the health bill which had just been signed into law by President Obama a couple of hours prior on that very morning. It was correctly acknowledged that provisions of the law were quite complex and that answers to some questions from the audience were not readily available at the moment.....Amen!

*continued on p.2*



## Inside The Newsletter

This issue of the Newsletter has special interest for RELAC's many veterans. Check out the invitation to **Supervisor Antonovich's gala veteran's event**. You can find out all about it on page 6. And on page 11 the **first of our Veteran's Corner** articles appears. This will be a regular Newsletter feature.

The May 14 deadline is fast approaching for sending in your reservation for the **Regional Luncheon in San Diego**. Information and a coupon will be found on page 3. It's a great opportunity to get valuable information and enjoy yourself.

Also coming up is **RELAC Day at Hollywood Park**. It's always a great party at the races. Details and a reservation form are on page 5. And right behind the races comes **RELAC's Dodger game**, complete with holiday fireworks. See page 3.

## Where Are You?

RELAC seems to have lost track of some of its members -- in most cases we believe they have moved and not given us their forwarding address. If you are in contact with any of the following "lost" RELAC members, please ask them to call us as at (800) 537-3522 or email us [admin@relac.org](mailto:admin@relac.org)

William Allen  
Marie Behan  
Eliza Calhoun  
Billie Davis  
Richard Griffith  
Maria Hodges  
Carolyn Jensen  
Eileen Kelly  
Pleaze Laster  
Frances Lone

Clarian Martin  
Marie Miller  
Arthur Nichols  
Kay Ongchangco  
Frances Park  
Ida Powell  
Jimmie Purefoy  
George Ricks  
Betty Sorensen  
Jeannette Trahan

## Retirement Board

by Ed Morris  
Alternate Retirement Board Member



### Health Care

There are many questions still unanswered with the signing of the Health Care bill, but LACERA will continue with the present health insurance and dental/vision benefit programs. President Obama has said over and over that if you like your program, and the sponsor likes the program, nothing will change. The Board of Retirement at their last meeting approved the rate renewal and benefit change recommendation of an overall increase of 4.5%. The dental/vision increase is 1.7%.

Be sure to read the 2010 Medical package which will be mailed to you in June and look for the new benchmark premiums for your amount of premium if any. Do not forget the six-month opportunity to transfer to another medical plan if for any reason you are unhappy with your current one.

On page 12 you can find what the speakers presented on the subject of Health Care at the March 23 General Membership Meeting.

## Thanks for RELAC's Food Donation



RELAC President Walia has received a gracious letter of thanks from Camelia Robles, Social Service Director of Our Lady of the Miraculous Medal Parish. She asked that we share appreciation with our members for RELAC's generous donation to the Parish of excess meals from the Installation Luncheon.

The reason for the excess meals was that very bad weather that day resulted in attendance at the Luncheon which was somewhat less than the number which had been expected.

The Parish, which is near the Quiet Cannon restaurant in Montebello where the luncheon was held, distributed the food to families registered with the food pantry operated by the Parish. These are families which, as Ms. Robles indicated, need a little extra help during these difficult financial times.

## Preserving Memory is Topic At June Membership Meeting

by George Hernandez  
Chair, Program Committee

RELAC's next General Membership Meeting is scheduled to be held on June 15, 2010 at the Elk's Hall in Canoga Park. We have lined up an excellent speaker with a super program. As we all must take an active role in protecting our memory wellness and brain health, we've invited Arnold Bresky, M.D. who is a renowned Alzheimer's and memory loss expert, to show us how to utilize the latest technology to help protect our brains, body and overall health. His lecture is motivating, educational and inspirational so please don't miss this opportunity to learn from Dr. Bresky, an award winning author and lecturer. His lecture includes the exact healthy steps you should take on a daily basis like drinking red wine, eating the right "brain" foods, laughing and participating in intellectually challenging activities with friends, keeping meaning and purpose in your life, and much more...



*President's Message continued from p.1*

### Sheriff Will Speak at Next Year's Luncheon

It is my pleasure to let you know well in advance that we are very honored to have Sheriff Lee Baca as our keynote speaker for the 2011 January Installation Luncheon at Almansor Court, Alhambra. Our Special Events committee will provide additional details on this in forthcoming issues of the Newsletter. We hope you can attend this great annual event.

You will find information on additional interesting events planned for 2010 on the inside pages of this issue.

On a sad note, we share the deep loss in the passing away of Rachel, Bill de la Garza's dear wife and pray for Bill, his family and friends for strength to bear this tragic loss and to rejoice in fond memories they shared together for so many years.



# REGIONAL ACTIVITIES

by Diane Sandoval

Co-Chair, Regional Support Committee

At the date of our newsletter deadline the Lancaster Regional Luncheon Meeting (scheduled on April 29, 2010) has not taken place. However, I'm confident our meeting will be a smashing success. Donna Livermore is a great hostess and has planned a great meeting for you. I'll give you a complete recap of the meeting in my next article.

## San Diego Luncheon Meeting on May 25

The deadline to send in your luncheon reservation is May 14, 2010. Remember you do not need to stay at the hotel to attend the luncheon. RELAC selected a great venue for this event. The Hotel is located directly across the street from the Star of India.

The Committee has planned a fantastic program. Mr. Robert Hill, LACERA Assistant Executive Officer, is attending to share the latest news at LACERA. I know he'll be ready to answer questions on Healthcare Reform and explain if it will impact your medical benefits.

Our Featured Speaker is Sergeant Mark Varnau, San Diego County Sheriff's Department. Sergeant Varnau supervises the Sheriff's Financial Crimes and Elder Abuse Units. His presentation will cover identity theft, elder abuse, on-line scams, investment fraud, medical fraud and other related crimes. I do my banking on-line so I am quite anxious to hear his presentation. Since I make it a point to carry a minimal amount of cash, I frequently use my ATM card for my daily purchases. I wonder if I'm at risk.

In addition to our Program, you will enjoy a delicious buffet lunch and yes there will be DOOR PRIZES! Send in your reservation form today along with a check payable to RELAC for \$22.00 per person. If you're concerned your reservation may not reach our office prior to the deadline, call our office and let staff know you are sending it so we can include you in our count. PLEASE COME JOIN US!

## Ventura Luncheon Meeting

Our meeting in Ventura will be held on September 15, 2010 at the Four Points by Sheraton Hotel, 1050 Schooner Drive, Ventura, CA 93001. More details to follow in the July/August newsletter. Until then, SAVE THE DATE!

### San Diego Regional Luncheon

Tuesday, May 25, 2010 – 11:30 a.m.

Holiday Inn on the Bay

1355 North Harbor Drive • San Diego, CA 92101

Buffet Luncheon - \$ 22.00 per person

Member(s) \_\_\_\_\_

Address \_\_\_\_\_

Guest(s) \_\_\_\_\_

Phone No. \_\_\_\_\_

Number of Tickets \_\_\_\_\_ x \$22.00 each \_\_\_\_\_

TOTAL\$ \_\_\_\_\_

Make checks to: RELAC

Mail to: 1000 S. Fremont Ave., Unit 15  
Alhambra, CA 91803-8802

More Info: Call RELAC (626) 308-0532;  
Toll Free: (800) 537-3522; email: admin@relac.org;  
Web Page: www.relac.org

**Deadline is May 14, 2010**

## BATTER UP!! RELAC Night at Dodger Stadium

by Mary K. Rodriguez



### FINAL CHANCE TO ORDER TICKETS!

This year the game between the Los Angeles Dodgers and the Florida Marlins will be held on Monday, July 5, 2010. (Dodgers staff stated game will start at 6:10 p.m. but time may be changed to 7 p.m. Tickets will reflect correct time.) It is also the night of A SPECTACULAR FIREWORKS SHOW. It seems this show gets better every year!

Tickets are \$20.00. The seats are located in the lower reserved section on the third base side. We have a limited number of reserved seats and they go quickly, so please fill out the coupon below and send it with your check as soon as possible.

**DEADLINE FOR TICKETS: JUNE 23, 2010  
OR UNTIL THEY ARE ALL GONE.**

Hope to see you there!!

### DODGERS VS. FLORIDA MARLINS

Game Starts at 6:10 p.m.

Monday, July 5, 2010

Name: \_\_\_\_\_

Address: \_\_\_\_\_

City: \_\_\_\_\_

Phone: (\_\_\_\_) \_\_\_\_\_

No. of tickets \_\_\_\_\_ @\$20.00 each = \$ \_\_\_\_\_

Total enclosed: \$ \_\_\_\_\_

Make checks payable to:

RELAC Baseball  
1000 So. Fremont Ave., #15  
Alhambra, CA 91803-8802

**Must be received by June 23.**

# HOME EQUITY

Make your  
**Dream Home**  
a **Reality**

Home Equity  
Lines starting at

**4.45%**  
APR\*



A home equity loan can be used for anything from paying off high-interest debt to home improvements to buying a car. Let the equity in your home improve your overall financial situation. With a low-rate Home Equity Loan or Line-of-Credit at Southland, you can do it all!

**Southland**

CREDIT UNION



## Home Equity Lines of Credit

- Variable rates as low as 4.45% APR\*
- Lines up to \$500,000
- HELOC Access Card

## Home Equity Loan Programs

- Fixed rates as low as 6.50% APR\*
- Loans up to \$750,000
- Repayment terms up to 30 years

**RELAC Members**  
Join and receive a  
free gift.\*\*

Membership is subject to eligibility. All new accounts will be verified through ChexSystems and are subject to credit approval and verification of equity. \*APR=Annual Percentage Rate. Rates quoted as of 04-1-10 and are based on 80% LTV. HELOC is a variable rate loan and index is based on 3-month average of 2-year Treasury Note currently at 0.917%+3.50%=4.417% for 80% LTV. Lifetime cap of 5% over fully indexed start rate. HELP rates for terms greater than 15 years are with 1 point. Add 0.50% for a zero point rate. The monthly payment is \$8.71 per \$1,000 at 6.50% for 15 years on fixed Home Equity Loan. The rate and payment shown assumes that you have a FICO of 700 or above. Other rates may apply based on credit profile. Rates are subject to change without notice. Loan fees applicable to products can range from \$155 to \$3,392 and vary significantly based on loan amount and individual circumstances. Property you own which generates income may not be eligible. Credit limit determined by the equity in the real property, which is used as security for the loan. \*\* Ask a representative for details. Offer good while supplies last.

**www.SouthlandCU.org • 800.426.1917**

## Public Pension Payments Provide Sizable Boost to California's Economy

by David Muir  
RELAC Member  
Retired LACERA Legal Counsel

A national study released in February 2009 documents the sizable impact public pension payments have on California's economy.

Often overlooked is the "multiplier effect" of public pension payments. The multiplier effect occurs because one retiree's spending becomes another person's income. Here's an example provided by the study. A retiree uses her pension money to buy a car. As a result of that purchase, the owner of the car dealership, the car salesman, and each of the companies involved in the manufacture of the car all see increases in income, and spend that income. In addition, the car dealership and the car manufacturers hire additional employees as a result of the increased business, and those employees spend their paychecks in the local economy.

The study's report, entitled "Pensionomics: Measuring the Economic Impact of State and Local Pension Plans," finds that California public pension payments during fiscal year 2005-2006 added more than \$34.5 billion to California's economy. That sizable economic impact:

- Supported more than 205,221 jobs that paid more than \$15.1 billion in total compensation to California workers.
- Supported more than \$6.1 billion in annual federal, state and local tax revenue.

- Paid \$23.5 billion in pension benefits to 976,233 retirees and beneficiaries.

- Had large multiplier effects. Each taxpayer dollar invested in California's public pensions supported \$7.91 in total economic activity, while each dollar paid out in benefits supported \$1.47 in economic activity.

The benefits of public pension payments become more pronounced during periods of economic downturn – like today. Public pension payments continue unabated and thus have a stabilizing effect on the faltering economy. Beth Almeida, a co-author of the study, points out that "retirees with a stable monthly pension income can continue to spend on basic needs, even during an economic downturn. In contrast, retirees relying solely on plummeting 401(k)s or individual retirement accounts likely are forced to retreat from spending precisely at the time when the California economy most needs stimulus."

For more information on the study, as well as other information regarding the value and advantages of public defined benefit pension plans, visit [www.nirsonline.org](http://www.nirsonline.org).

## HOME EQUITY

Make your  
**Dream Home**  
a Reality

Home Equity  
Lines starting at

**4.45%**  
APR\*

A home equity loan can be used for anything from paying off high-interest debt to home improvements to buying a car. Let the equity in your home improve your overall financial situation. With a low-rate Home Equity Loan or Line-of-Credit at Southland, you can do it all!



### Home Equity Lines of Credit

- Variable rates as low as 4.45% APR\*
- Lines up to \$500,000
- HELOC Access Card

### Home Equity Loan Programs

- Fixed rates as low as 6.50% APR\*
- Loans up to \$750,000
- Repayment terms up to 30 years

Membership is subject to eligibility. All new accounts will be verified through ChexSystems and are subject to credit approval and verification of equity. \*APR=Annual Percentage Rate. Rates quoted as of 04-1-10 and are based on 80% LTV. HELOC is a variable rate loan and index is based on 3-month average of 2-year Treasury Note currently at 0.917%+3.50%=4.417% for 80% LTV. Lifetime cap of 5% over fully indexed start rate. HELP rates for terms greater than 15 years are with 1 point. Add 0.50% for a zero point rate. The monthly payment is \$8.71 per \$1,000 at 6.50% for 15 years on fixed Home Equity Loan. The rate and payment shown assumes that you have a FICO of 700 or above. Other rates may apply based on credit profile. Rates are subject to change without notice. Loan fees applicable to products can range from \$155 to \$3,392 and vary significantly based on loan amount and individual circumstances. Property you own which generates income may not be eligible. Credit limit determined by the equity in the real property, which is used as security for the loan. \*\* Ask a representative for details. Offer good while supplies last.



**RELAC Members**  
Join and receive a  
free gift.\*\*

**www.SouthlandCU.org • 800.426.1917**

## Public Pension Payments Provide Sizable Boost to California's Economy

by David Muir  
RELAC Member  
Retired LACERA Legal Counsel

A national study released in February 2009 documents the sizable impact public pension payments have on California's economy.

Often overlooked is the "multiplier effect" of public pension payments. The multiplier effect occurs because one retiree's spending becomes another person's income. Here's an example provided by the study. A retiree uses her pension money to buy a car. As a result of that purchase, the owner of the car dealership, the car salesman, and each of the companies involved in the manufacture of the car all see increases in income, and spend that income. In addition, the car dealership and the car manufacturers hire additional employees as a result of the increased business, and those employees spend their paychecks in the local economy.

The study's report, entitled "Pensionomics: Measuring the Economic Impact of State and Local Pension Plans," finds that California public pension payments during fiscal year 2005-2006 added more than \$34.5 billion to California's economy. That sizable economic impact:

- Supported more than 205,221 jobs that paid more than \$15.1 billion in total compensation to California workers.
- Supported more than \$6.1 billion in annual federal, state and local tax revenue.

- Paid \$23.5 billion in pension benefits to 976,233 retirees and beneficiaries.

- Had large multiplier effects. Each taxpayer dollar invested in California's public pensions supported \$7.91 in total economic activity, while each dollar paid out in benefits supported \$1.47 in economic activity.

The benefits of public pension payments become more pronounced during periods of economic downturn – like today. Public pension payments continue unabated and thus have a stabilizing effect on the faltering economy. Beth Almeida, a co-author of the study, points out that "retirees with a stable monthly pension income can continue to spend on basic needs, even during an economic downturn. In contrast, retirees relying solely on plummeting 401(k)s or individual retirement accounts likely are forced to retreat from spending precisely at the time when the California economy most needs stimulus."

For more information on the study, as well as other information regarding the value and advantages of public defined benefit pension plans, visit [www.nirsonline.org](http://www.nirsonline.org).



# Have Fun with RELAC at Hollywood Park

by Mary K. Rodriguez  
Chair, Recreation Committee

## LAST CALL TO ORDER TICKETS!!

It's time again for us to enjoy a fun day at Hollywood Park.

RELAC DAY AT Hollywood Park will be on Thursday June 10, 2010.

Great News! The ticket price remains the same as last year - \$28.00 per person. This price includes admission, a great buffet lunch with fresh baked cookies for dessert, and soft drinks. A program and valet parking are also included.

Please fill out the coupon below as soon as possible and send it along with your check. The deadline is May 27, 2010. Your tickets will be mailed to you on June 3, 2010.

I'm looking forward to meeting you ... So, see you then when we can hear  
"And they're Off and Running!"



## RELAC DAY AT THE RACES

Hollywood Park RaceTrack  
Thursday, June 10, 2010

Name: \_\_\_\_\_

Address: \_\_\_\_\_

City: \_\_\_\_\_ State \_\_\_\_\_ Zip \_\_\_\_\_

Telephone ( \_\_\_\_\_ ) \_\_\_\_\_

No. of tickets \_\_\_\_\_ @ \$28.00 Ea = \$ \_\_\_\_\_

TOTAL \$ \_\_\_\_\_

Enclose a check (no cash please) for your total payable to RELAC and mail to:

1000 S. Fremont Ave., Unit 15  
Alhambra, CA 91803-8802

**Must be received by May 27**

For Office Use:

Date Rec: \_\_\_\_\_ Amt \$ \_\_\_\_\_ Check # \_\_\_\_\_

## Investments Board



by Diane Sandoval  
Retiree Representative,  
LACERA Board of Investments



At the March Board Meeting, LACERA's actuary, Milliman, presented the results of the June 30, 2009 Valuation. As expected, LACERA'S Funding Ratio decreased to 88.9% compared to 94.5% a year ago. I say this was expected because of the investment losses LACERA experienced as a result of the recent financial crisis. You may recall in an earlier article I reported that the investment return of the LACERA portfolio for the fiscal year ended June 30, 2009 was a negative 18.3%.

As stated in staff's memo to the Board, Valuation reports are often described as snapshots of a retirement plan's funded status at a particular point in time. This year's snapshot finds LACERA funded at 88.9%. In other words, the estimated benefit liability is greater than the value the actuary places on the Plan's assets.

According to the Report, the size of the active member population increased 1.4% and now totals over 95,000 with an average age of 45.4. Over 97% of active employees are members of the open tiers (Plans D and E, and Safety Plan B), with less than 3% of active members covered by one of the closed plans (Plans A, B and C, and Safety Plan A). We retirees increased 1.4% and now total over 53,000. The average benefit payment increased by 4% to approximately \$3,275 per month and the average age of retirees increased by approximately three months to 71.4.

Although I remain cautious about the financial markets, LACERA's portfolio has continued to show improvement since June 30, 2009. According to the latest report from Lisa Mazzocco, LACERA Chief Investment Officer, the estimated market value of the portfolio as of February 28, 2010 was \$34 billion (a slight increase since January 31, 2010 - \$33.8).

As always, thank you for your interest and support. I look forward to seeing you at a future meeting. Take care and enjoy your retirement!



**MICHAEL D. ANTONOVICH**  
**LOS ANGELES COUNTY SUPERVISOR**

*Invites You*  
*to the 13<sup>TH</sup> Annual Veterans' Event*



**REMEMBERING OUR VETERANS  
& THEIR FAMILIES,  
PAST, PRESENT AND FUTURE**

**SATURDAY, MAY 29, 2010 - 10 A.M. TO 3 P.M.**

**ARCADIA COUNTY PARK  
405 S. SANTA ANITA AVENUE, ARCADIA 91006**

**FEATURING**

- SKYDIVERS
- FLYOVER BY WWII FIGHTER PLANES
- FOOD BOOTHS
- LIVE MUSIC

**NO COST**

- IMMUNIZATIONS
- HAIRCUTS/MANICURES
- HEALTH SCREENINGS

**ASSISTANCE**

- EMPLOYMENT INFORMATION
- VETERANS BENEFIT INFORMATION
- LEGAL INFORMATION

**WorkSource**  
CALIFORNIA  
www.worksourcecalifornia.com  
888-226-6300



A SPECIAL TRIBUTE TO OUR ARMED FORCES  
WILL BE HELD AT 11:30 A.M.

BRING A DUPLICATE OF A MILITARY PHOTO  
TO BE PLACED ON  
THE "WALL OF REMEMBRANCE"

FREE ADMISSION

EVENT WILL BE HELD RAIN OR SHINE

FOR MORE INFORMATION  
CALL 626-967-1441 OR 909-394-2264.

Community & Senior Services  
Adult Protective Services  
HOT LINE: (877) 477-3646



The County of Los Angeles is an equal opportunity employer and, upon request, will provide reasonable accommodation for qualified individuals with disabilities.

## RELAC NEWSLETTER

Vol 45 - May/June 2010

Number 3

Retired Employees of  
Los Angeles County  
1000 S. Fremont Ave.

Unit 15, Alhambra, CA  
91803-8802

(626) 308-0532

(800) 537-3522

Fax (626) 308-2901

E-mail: admin@relac.org

Board of Directors

President

**Greg Walia**

Vice President

**Ida Leon Ramos**

Secretary

**Mary Lou Bangar**

Treasurer/ Past

President

**Edward C. Morris**

Members

**Bill de la Garza**

**Domingo Delgado**

**Martin Golds**

**Raymond R.**

**Guyovich**

**George Hernandez**

**Alice Prouty**

**Marianne Reich**

**Mary K. Rodriguez**

**Diane Sandoval**

**Raul Solis**

Emeritus

**Dave E. Kalingar**

Editor: Martin Golds

Copyright © 2010 by

RELAC This information  
presented in your RELAC

Newsletter is believed

to be from reliable

sources. However, no

responsibility is assumed

by RELAC or the writers

for inaccuracies in the

articles as published.

Office Hours

9:00am - Noon &

1:00pm - 4:00pm

Monday - Thursday

Closed Friday,

Saturday, Sunday &

Public Holidays

website: www.relac.org

## Golf News

By Gil Sandoval  
RELAC Golf Director



## La Mirada Golf Tournament March 22, 2010



The golf gods gave us beautiful weather and all the players were at their best. Bob Cornelius in the "C" flight won with the lowest net of the day, a (57). He was chased by Ed Petterson and Don Kirkman, who finished 2nd and 3rd. I guess Bob will be moving into the "B" flight because of his fine, consistently good play.

Benny Martinez won the "A" flight by 2 strokes over Jim Noyes and Bob Bogawa. Darryl Christopher won the "B" flight in a card off with Jim Abbott.

Kathy Malmfeldt was an easy winner in the Ladies flight as her net 61 was 5 strokes up on Kay Barents and Nancy Signer who were playing well also.

### "A" Flight Winner (19 and under)

1st Benny Martinez (62)

2nd Jim Noyes (64)\*

3rd Bob Bogawa (64)

### "B" Flight (20-27 Handicaps)

1st Darryl Christopher (64)\*

2nd Jim Abbott (64)

3rd Luis Martinez (66)

### "C" Flight (28 up Handicap)

1st Bob Cornelius (57)

2nd Ed Petterson (62)

3rd Don Kirkman (64)

### Ladies

1st Kathy Malmfeldt (61)

2nd Kay Barents (66)\*

3rd Nancy Signer (66)

\*Won in card off

### Closest to the Pin on Par 3's

#### Men

# 3 Darryl Christopher

# 5 Steve Wilke

# 9 Shig Yonamine

#11 Mike Marmfeldt

#13 Jim Guild

#17 Jerome Clayton

#### Women

# 3 Lil Hamasu

# 5 Sue Danbara

# 9 Charlene Debie

#11 Sue Danbara

#13 Nancy Signer

#17 No Winner

**NEXT TOURNAMENT – Monday, June 7, 2010**  
**Los Amigos Golf Course 8:00 A.M. start**  
**Entry Deadline May 14, 2010**

## RELAC Golf Entry Form



Los Amigos Golf Course  
7295 E. Quill Drive  
Downey, CA 90242

**Monday, June 7, 2010**  
**8:00 am Start**

Please Print

1. Name \_\_\_\_\_

Address \_\_\_\_\_

City \_\_\_\_\_ Zip \_\_\_\_\_

Phone \_\_\_\_\_

Fees: \$32.00 PER GOLFER - CART EXTRA

If possible, place me in a foursome with below listed  
golfers. Addresses of all golfers MUST be included.

If possible, we would prefer an  
Early \_\_\_\_\_ Late \_\_\_\_\_ starting time.

2. Name \_\_\_\_\_

Address \_\_\_\_\_

City \_\_\_\_\_ Zip \_\_\_\_\_

Phone \_\_\_\_\_

3. Name \_\_\_\_\_

Address \_\_\_\_\_

City \_\_\_\_\_ Zip \_\_\_\_\_

Phone \_\_\_\_\_

4. Name \_\_\_\_\_

Address \_\_\_\_\_

City \_\_\_\_\_ Zip \_\_\_\_\_

Phone \_\_\_\_\_

**NOTE: Only ONE GUEST per member.**  
Enclose check for \_\_\_\_\_ golfers @ \$32 per  
Golfer. Make checks payable to RELAC  
Golf. Mail entry to RELAC GOLF, 1000  
So. Fremont Ave., #15, Alhambra, CA  
91803-8802

**Entry Deadline**  
**May 20, 2010**  
**ALL CHECKS MUST BE**  
**IN RELAC OFFICE**

For Office Use:

Date Rec. \_\_\_\_\_ Amt.\$ \_\_\_\_\_ Ck# \_\_\_\_\_



# Members Spotlight



## Department of Beaches and Harbors Offers Free Parking Passes to Seniors



ATTENTION SENIORS (62+). Interested in receiving a free daytime parking pass to visit Los Angeles County beaches Monday through Friday except holidays? Here's what you do. Send a photocopy of your driver's license and your auto registration to Department of Beaches and Harbors, 13837 Fiji Way, Marina del Rey, CA 90292. It takes about two weeks to receive your pass in the mail. No passes are issued over the counter. Enjoy your free parking pass when visiting beaches in Malibu, Pacific Palisades, Santa Monica, Venice, Playa de Rey, Torrance, and White Point in San Pedro. For more details call (310) 305-9503.

## Retired Probation Staff Monthly Meetings

L. A. County retired Probation Officers and other personnel meet on the last Friday of each month at 11:30 a.m. at the Woodland Hills Promenade food court. (Topanga Canyon & Oxnard Street)

Please join us for lunch, reunion, and great conversation!

Herb Zipperstein  
Woodland Hills, CA

## Welcome New Members

### February – March 2010

#### Assessor

Bonnie L. Oliver

#### Chief Executive Office

Sharon N. Yonashiro

#### Children & Family Services

Romalis J. Taylor

#### Fire

John "Jack" Ricci

#### Health Services

David S. Rodriguez

#### LAC-USC Medical Center

Robert Caudillo

#### Probation

Lawrence Shelburne

#### Public Defender

Rebecca Schreiber

#### Public Works

Dean Efstathiou

#### Suzanne L. Farrell

Tom Hoagland

#### Superior Court Officers

Mary Sherman Stout

#### New Affiliate Member

#### District Attorney

Alex Luna



## PLANNING FOR 2010 DEPARTMENT OF PERSONNEL REUNION LUNCHEON

by Catherine "Cate" Oliver

The planning stage for the annual *DOP Reunion Luncheon* is underway. Each year retirees and those still working for L.A. County attend the luncheon. It is a great way to keep in touch with, and renew, those old DOP friendships, as well as enjoy a great meal!

Prior to my retirement this past February, I was asked to take the lead in coordinating this year's DOP Reunion Luncheon. The first order of business is to put together a mailing list.

Those of you interested in attending the 2010 DOP luncheon please send your Name, U.S. Mail address, Phone Number, and E-mail address to the AOL e-mail address, shown below. Please be assured that personal information gathered for the purpose of sending out informational flyers and updates during the year regarding the reunion, or other "old" DOP events, will remain strictly confidential unless you provide your written permission to disseminate the information.

Please send your contact information, via e-mail, to [DOPReunion@AOL.COM](mailto:DOPReunion@AOL.COM). Or, I may be reached by phone at 626-414-4436. Lets make this year's reunion the best ever! I hope to see all of you there!



## Volunteer Opportunities Helping Others Can Help You

by Elizabeth Rose, Program Manager  
Wise & Healthy Aging Services



It's true. A recent AARP Magazine article says that you can keep your mind sharper by seeking out new activities, in addition to doing puzzles and other challenges. A 2009 Johns Hopkins study of people ages 70-79, revealed that exercising, working or volunteering and interacting with others, helped 30 percent of people maintain – or improve – their mental performance.

That is where the nonprofit RSVP/WISE & Healthy Aging Volunteer Services can help. If you would like to help others and meet new people, you may enjoy participating in the Fraud Fighters Program in Santa Monica. At the WISE & Healthy Aging Call Center you can fight fraud by making phone calls to inform people about the latest scams. You will call older consumers throughout the country and inform them on how to protect themselves from fraud and refer them to law enforcement if they have been a victim.

You'll get training, parking, snacks, coffee and lunch for as little as three hours a week. And you will have the opportunity to participate in monthly social activities if you choose. If you are not sure you want to be a Fraud Fighter, we have plenty of other volunteer opportunities at various locations to keep your mind sharp!

The nonprofit Senior Fraud Prevention Call Center is located at 1527 4th St., Santa Monica 90401. Call today and get started. For more information, please call (310) 394-9871, ext. 450.

## RV Outing Notes



Ed Clifton  
Coordinator of RV Club



Seventeen rigs enjoyed our outing to Mountain Valley RV Resort in Hemet, CA. The weather was very nice, but sometimes windy. Although rain was forecast, it blew right over and we didn't have to run for cover or stay inside. Lots of good food was enjoyed by all, and even a few stories were spread around (where's my boots).

Dian Stegall told our group about a program to purchase dog tags for children of soldiers stationed in Iraq and Afghanistan. It is a way for children to feel closer to their mothers or fathers while they are away from home. As I understand it, \$80 was collected to be donated to the program in our clubs' name. Way to go guys! Our next outing is on May 9-10-11-12 at Chula Vista RV Resort. Bill & Janice Hayhurst will be the Wagon Masters.

## CHECKING



FREE Checking that Pays  
**1.50%** APY\*



There are only three free and easy requirements to qualify:

- 1 Use your Southland Check Card for at least 10 purchases per month
- 2 Make one ePay, Direct Deposit, or ACH debit transaction per month from your **FREE SUPER CHECKING** Account
- 3 Receive Southland eStatements



- Free Checking that earns 1.50% APY\* with no minimum balance requirements
- ATM fees reimbursed up to \$20 per month
- Rewards Plus Program includes: Purchase Protection and Extended Warranty, Cash Rewards, Rebate Rewards, Savers Club, and so much more!
- Free Online Banking
- Free Identity Theft Insurance
- More surcharge-free ATMs than the largest banking network

Membership is subject to eligibility. All new accounts will be verified through ChexSystems and are subject to approval. \*APY=Annual Percentage Yield. Rate quoted 4-1-10 and is subject to change without notice. To qualify, accounts must have eStatements, 10 Check Card purchase transactions, and one ACH direct deposit, debit, or ePayment per month to earn qualifying rate and ATM refunds. Qualifying rate, currently 1.50% APY, will be paid on balances up to \$50,000. On balances over \$50,000 a lower dividend rate will be paid, currently .10% APY. Non-qualifying accounts will receive a .10% APY dividend rate and no ATM fee refunds will be paid. Reimbursed ATM fees include third-party surcharges and Southland out-of-network fees. \*\*Rewards Plus Program is a companion product to your Southland Checking Account and is available for a \$5 monthly charge. You must enroll for Rewards Plus to receive the benefits and insurance coverage offered. See Rewards Plus Program New Account Kit for complete program details.

**www.SouthlandCU.org • 800.426.1917**





## Letters To The Editor

Thank you for all for the information in the RELAC Newsletter. I appreciate very much reading the information and about your activities which I am unable to participate. Enclosed is a small amount for all the mailing you do. Thank you again.

Sally Hayashi

Seattle, WA

*Sally, Your contribution is very much appreciated.*

To all of RELAC and whoever drew my name for the Valentine Day drawing: A sincere thank you. It came in handy. Took my wife of 66 years to dinner for our anniversary.

Joaquin Mascorro

Santa Maria, CA

Dear RELAC:

Thank you for the birthday card. It doesn't seem possible that I have been retired for 32 years this month. Thank you again for the card.

Eugene McMurray

Anaheim, CA

*Unfortunately space did not permit printing all of the letters of appreciation for Valentine drawing prizes. The grateful writers were Hanako Nakamoto, Florence Harms, Natalie Scotton, Jodi Dempsey, Norma Tucker, Dorothy Karssen, and Alma Aghbasian. We are grateful for their letters.*

Editor:

Just finished reading March/April 2010 Vol 45-2 issue of the RELAC Newsletter – wanted to let you know what a TERRIFIC edition this was – great use of color, well organized, pleasing to read – LOTS of great information – Kudos in triplicate+! At this time, I am also taking an online Desktop Publishing w/MS 2007 and as far as I can see, you have developed a product that has all the earmarks of good publication design – focus, balance, effective use of color, readability, and interest to target audience to name just a few. I thought it was SO good that were I to live closer to what's going on I would be attending RELAC meetings – but, Spring Creek, NV is about 4 hours from

everywhere and 8 hours from places known as "somewhere" ... and I like it like that.

As a staff person for the non-profit membership organization Nevada Farm Bureau, we too publish a Monthly and Quarterly Newsletter and share the same membership and financial concerns of RELAC. So, here's to us both for survival and success as years progress – but you have come up with a really outstanding newsletter!

Stephanie Licht

Surviving Spouse of Armond J. Licht

*The RELAC Officers, Board of Directors, volunteers and staff are gratified to receive the many letters of appreciation from RELAC's members. They help assure us that our efforts are worthwhile. Of course the hearts of the Newsletter editor and our contributors are especially warmed by the letter, just above, from Stephanie Licht. But we also want it known that he will happily publish letters which are critical of the Newsletter or of any of the other services RELAC provides its members. Don't hesitate to let us know what you think.,*



## Reminder: How to Become a Member of the RELAC Board

To be considered for selection by the Board to the slate of nominees to fill the five Board member positions up for election this year, you have until May 10 to submit a letter to the RELAC office. The letter should explain your interest in serving and your qualifications. Before you are considered by the Board on May 25 you will be interviewed by the Nominations and Elections Committee.

Any member who wishes to be a candidate, and who has not been selected to be on the slate, must file a petition signed by at least 25 RELAC members. The signed petition with a letter of acceptance of the nomination must be received by the RELAC office no later than July 30. Petition forms are available at the RELAC office.

If there are at least six persons competing for the five Board positions there will be an election in the the month of September.





## News From LACERA

by Janice Golden  
Assistant Executive Officer

### Does your family know what to do if you should pass away?

As much as none of us likes to dwell on it, the time will come. We can make it a bit easier on our loved ones by making sure they know how to expedite the survivor benefits process.

When a retired LACERA member dies, his or her beneficiaries may be eligible for benefits such as a monthly survivor allowance, survivor health care medical/dental plans, and/or a \$5,000 lump-sum death benefit.

The first thing the beneficiary should do is call LACERA at 1-800-786-6464 and report the retiree's passing. This will start the process, so LACERA can ensure all eligible beneficiaries are paid in a timely manner.

One of the things you could do now, so your beneficiary won't have to do it later, is to make certain LACERA has all the documents we will need to process any future benefits. This includes:

- Your original certified marriage certificate or Certificate of Registered Domestic Partnership (if you have an eligible spouse or domestic partner and a copy is not already in your LACERA file)
- Original certified birth certificates for all eligible children

If you can't recall whether you submitted these documents to us, call the 800 number above; our staff will be happy to check your records. After we review the original certificates, we will scan them into your online record and return them to you.

In addition, it is important that LACERA maintains updated beneficiary information for each member, such as name, address, etc. A good way to keep up with this is to carefully review the Annual Benefit Statement LACERA mails you during your birthday month. If any of the beneficiary information listed is incorrect, follow the instructions provided to complete the correction form and return it to LACERA. (If the information listed is correct, no action is required on your part.)

There will still be things your beneficiary will need to attend to in the event of your death; but rest assured, LACERA will be available to help him or her through the process. For more beneficiary information, visit [lacera.com](http://lacera.com). Click on the "Benefits" tab at the top of the page and select "Retired Member." In addition, you may read, print, or order our Survivorship brochure online from the Brochures & Forms page.



## Veteran's Corner



Headstones and markers are furnished to eligible spouses and family members of veterans who are interred in a national military post/base, or state veterans cemetery. For veterans who have chosen columbaria internments, niche markers are also available. Public law 110-157, signed on December 26, 2007, allows the Department of Veterans Affairs (VA) to furnish government headstones or markers for the graves of eligible veterans who died on or after November 1, 1990, regardless if the grave is already marked with a privately purchased headstone or marker. The law gives VA authority to furnish, upon request, a medallion or other device of a design determined by the Secretary to signify the deceased's status as a veteran, to be attached to a headstone or marker furnished at private expense. The benefit will be available in lieu of government furnished headstones or marker, for veterans in privately marked graves who died on or after November 1, 1990. The VA is currently designing the medallion and it is expected to be available soon. Claims will be accepted once a contract has been awarded for its manufacture.

When burial or memorialization is at a national, post or state veterans cemetery, a headstone or marker may be ordered by the cemetery officials based on inscription information provided by the next of kin. When burial is in a private cemetery, VA form 40-1330 must be submitted by the next of kin or representative, such as funeral director, cemetery official or veterans counselor, along with veteran's military discharge documents, to request a government provided headstone or marker.

Additional information is available online at [www.cem.va.gov/hm/hmtype.asp](http://www.cem.va.gov/hm/hmtype.asp) or by contacting your local County Veteran Service Officer (CVSO). In most cases you can locate your CVSO or regional veteran service office in your phone book in the "Government" section.

*The above information is derived from the Honors Newsletter, a government publication. It was submitted by RELAC Board Member, George Hernandez.*

**Readers are invited to submit articles of interest to vets.**

## For Sale

**CEMETERY LOTS** – Two lots Rose Hills, Whittier – Mariposa Terrace, Graves 3 & 4, Lot 843. \$3,000 each. Call (480) 515-1893.

**5TH WHEEL TRAILER** – 2004 – 3400RL Montana 5th Wheel – Asking \$29,500. Call Margie (909) 338-1748.

**CEMETERY LOTS** – Two lots Forest Lawn, Covina. Valor Section, Plot 1631, spaces 2 and 3 on hill overlooking San Gabriel Mountains. \$1,295 or best offer per plot. Call Tracy (310) 980-8117 or email: [tracypfau@yahoo.com](mailto:tracypfau@yahoo.com).

**RV** – Like new Fleetwood '04 Tioga Class C, Model 24D, Ford V10 engine, low mileage. \$42,500 or best offer. Call Denis (626) 794-8444 or email: [mcdenis@gmail.com](mailto:mcdenis@gmail.com).

# Health Care Reform is Main Topic at Arboretum Meeting

## *Also featured: big turnout, fine weather, peacock calls*

March 23 was a fine day and there was a full house at the Los Angeles County Arboretum. There were 270 RELAC members and guests in attendance to hear how the newly passed Federal health care legislation will affect the health benefits of County retirees. As it happened, President Obama signed the major health care bill that very morning; excellent planning on the part of the Program Committee led by its Chair, George Hernandez. Probably not a part of the committee's plans, from time to time a noisy peacock punctuated the speakers' presentations with his loud calls.

After RELAC President Greg Walia opened the meeting, Brian Mejia, Deputy to Supervisor Mike Antonovich, welcomed the audience to the 5th District. On behalf of the Supervisor, the Deputy presented scrolls, honoring the many years of service of three recently retired RELAC Board members, John Fleming, Fred Miller and Sol Fingold. RELAC itself was recognized for its service to County retirees.

### The Country's and the County's health care problems

Leading off the discussion of Health Care Reform was Gerardo Pinedo, Director of Government Relations and Policy, Department of Health Services. He outlined the elements of America's health care problems, including 47 million people uninsured and rising premiums adding to the numbers of uninsured. In Los Angeles County there are two million uninsured, contributing to 2.7 million visits to emergency departments in four County hospitals. Pinedo then described the progress of the reform legislation through the houses of the U.S. Congress. He credited the Board of Supervisors and local non-governmental health-interested organizations with having effectively lobbied congress on behalf of the County's interests.

### Reform's impacts on County retired employees

LACERA Assistant Executive Officer Robert Hill provided a highly informative and useful review of the main provisions of Health Care Reform, identifying those which may impact retired County employees. To begin he emphasized that the Retiree health care plans remain in full force. Mr Hill indicated that LACERA staff is busy reviewing the 2500 pages of legislation, but at this point LACERA does not anticipate any major changes for the 40,000 retirees who receive health benefits.

Some of the impacts which Hill identified follow:

As a consequence of the Health Care Reform legislation it is expected that over 30 million persons who are not insured will become insured. The practical impact of adding 30 million new persons may temporarily strain the health care system. As a result, many health care experts are predicting that access to health care services in the form of doctor visits may be slightly delayed.

Also the new legislation requires the elimination of lifetime caps on medical benefits and extends coverage to dependent's children to the age of 26. Both of these mandated plan design enhancements are being reviewed by LACERA for inclusion into the LACERA plan design.

The legislation proposes a "standard level of care" which is not yet defined, but Hill assured us that LACERA's health coverage insurance policies all provide a high level of care and that they will meet or exceed whatever standards are eventually defined.



Amidst the beautiful surroundings of the County Arboretum are featured speakers Gerardo Pinedo of the Health Services Department, on the left, and Robert Hill of LACERA, on the right, with RELAC President Greg Walia between them. (photo by Ida Ramos)

The new legislation is reducing the amount of reimbursement for certain Medicare Advantage programs. The impact of this reduction is unknown. However, LACERA offers many insurance products including PPO's, HMOs and Medicare Coordinated plans. And as always, LACERA staff is available to help members review and select the best insurance coverage for their particular lifestyle.

Many of the health care reform provisions are not scheduled to be implemented until 2014 and some even later. Hill stated that LACERA is well positioned to provide quality health care coverage to Los Angeles County retirees. Hill reminded everyone, it's business as usual, continue to eat healthy, exercise and schedule your customary doctor appointments.



Supervisor Antonovich's Deputy Brian Mejia, in the center, has just presented scrolls honoring former RELAC Board members John Fleming, on the left, and Fred Miller, on the right, for their lengthy and valuable service. (photo by Ida Ramos)



# RELAC Geared to Respond to Press Attacks on Public Employee Pensions

by Martin Golds  
Chair, Retiree Information Committee

No doubt many of RELAC's members are aware that both the print press and internet bloggers have been waging a sustained attack on public employee pensions. State and local retirement systems throughout the nation have been targets of attack, but California systems have been given special attention. Public sector pensions are accused of being excessively generous at the expense of taxpayers and creating the risk of bankrupting public jurisdictions. Some retirement systems have been alleged to be corrupt.

Anticipating that Los Angeles County's retirement system may be targeted, the RELAC Board established a committee to monitor the press and, when appropriate, to respond to criticisms of our system which are unjustified. For the most part we have found that L.A. County's retirement system has not been singled out as a target of press attacks. We believe that is because our system, as managed by LACERA, provides deserved benefits without the taint of corruption.

L.A. County did receive attention when it was disclosed that the retirement system will require increased contributions from the County. The Daily News published both an article and an editorial which suggested that the County's pensions are unduly generous and are an unreasonable burden on the County. A letter to the Daily News' editor from RELAC President Greg Walia made the following points:

- Los Angeles County pensions are not excessive. The average pension of general members as of June 30, 2009 was \$33,216.
- Over the last twenty years 80% of the cost of pensions has been paid from returns on investments and employee contributions, rather than the County.
- The shortfall results from the impact of the recession on the return from the retirement fund's investments, clearly a temporary problem.
- Beginning in 1977 the County has taken major steps to bring pensions in line with those provided by the private sector.

Unfortunately the Daily News did not choose to print our letter. But maybe the staff got the message.

If you spot negative reporting on the County retirement system, please inform the RELAC office promptly. And feel free to write your own letter to the offending newspaper. In our view it is not productive for us to respond to criticisms of the retirement systems of other jurisdictions.

**Touring With Great Western**  
626-578-1161 • 800-344-7090  
**Don't forget to ask for your RELAC discount!**  
CST# 1016229-40

## Great Basin National Park Lehman Caves



### Pony Express Territory Austin - Eureka - Ely Tour Price Includes

- \* Deluxe Motorcoach Transportation
- \* 5 Nights Accommodations **Share Twin: \$799.00**
- \* 11 Meals: Included **Single: \$949.00**
- \* Nevada Northern Railroad Excursion
- \* Guided Tour of Austin, Eureka & Ely
- \* Great Basin National Park and Lehman Caves
- \* Valley of Fire State Park **Historic Highway 50 - The Loneliest Road**
- \* Driver's Gratuity **6 Day Motorcoach Tour**
- \* Taxes & Baggage Handling **Departs: June 13, 2010**

## California & Oregon Coast - Rail & Sail -

Departs September 13, 2010

**CRATER LAKE - VANCOUVER - LOS ANGELES**

**9-Day Rail/Cruise Tour**

**1 Night Coast Starlight • 4 Nights Land**

**• 3 Nights Coral Princess**

**Tour Price Includes**

- One Way Rail L.A./Klamath Falls - Oregon (bedroom, **all meals** and wine tasting optional)
- 3 Night Cruise - *Coral Princess* (**all meals** and entertainment aboard ship)
- Port Charges and Government Fees • Deluxe Motorcoach Transportation
- Four Nights Land Accommodations with Four Breakfasts & 3 Dinners
- All Transfers • Taxes & Baggage Handling

### Cruise and Amtrak Deluxe Bedroom

Category	Stateroom	Double Per Person
JJ	Inside	\$1919.00
F	Ocean View (obstructed)	\$1959.00
D	Outside	\$1999.00
BE	Balcony	\$2099.00

### Cruise and Amtrak Standard Bedroom

Category	Stateroom	Double Per Person
JJ	Inside	\$1639.00
F	Ocean View (obstructed)	\$1679.00
D	Outside	\$1769.00



## IN MEMORIAM

*This list includes retired employees, both RELAC members and non-members.*

*\* denotes RELAC members*

### **Alcohol/Drug. Pgms. Admin.**

Rodriguez, Bessie

### **Antelope Valley Rehab. Center**

Collis, Marjorie L.\*

### **Assessor**

Baskerville, Aleta

Glade, Anna F.

Golden, Katherine

Grigsby, Lurlean

Krull, Roy K.

McIntyre, C. John\*

Millan, Carlos M.

Myers, Ethel J.

Supple, Mary E.\*

### **Child Support Services**

Owens, Juvonia E.

Patterson, Arstella

### **Children Services & Family**

Carter, Frances G.\*

Fukawa, Dollie K.\*

Platas, Naomi V.\*

Ravitz, Bernard\*

Rosales, Jacinta A.

Zolla, Barbara

### **Community & Sr. Citizens Svcs.**

Lopez, Lucy C.

### **Data Processing**

Bishop, Jack D.

O'Donohue, Marie P.

### **District Attorney**

Fritz, David T.\*

Miller, Helen L.

Miner, John W.

Stefanowich, Gertrude E.\*

Stovitz, Aaron H.

### **Engineer/Airports**

Frazier, Donald M.\*

### **Engineer/Facilities**

Gschwind, Max A.

### **Facilities Management**

Haser, Raymond A\*

### **Fire**

Donohue, Frank

Frownfelter, William M.\*

Giovannetti, Edward A.

Jenks, La Verne O.\*

Nichols, Dale W.\*

Stowell, Ray S.\*

Vartan, Bill W.

West, Robert G.\*

### **Flood Control**

Israel, Margie M.\*

### **Harbor/UCLA Medical Center**

Casebolt, Margaret H.\*

Dalbey, Romalee\*

Duresseau, Estelle

Guillermo, Redempta O.

Manzano, Alonso O.\*

McCard, Viola\*

Strain, Lola

Thompson, Bertha M.

### **Health Services**

Bloesch, Olga M.\*

### **Health Services Adm.**

Borreson, Marion Y.\*

Lewis Jr., Jack

### **Hospitals**

Epler, Pauline S.\*

Paez, Ruth H.\*

### **High Desert Health Systems**

Clanton, Ethel M.\*

### **Internal Services**

Gil, Frank S.

Kazaryan, Varuzhan

Wisniewski, Arthur A.

### **Juvenile Court Health Services**

Collins, Mary L.

Kinard, Barbara J.\*

Phillips, Vernon N.

Striano, Edna M.

### **King/Drew Medical Center**

Benn, Eva M

Churchill, Lily B.

Collier, Lucius

Davis, Moses

Fielder, King G.

Scano, Betty L.

Wadley Jr., Barney\*

Washington, Arzie\*

### **LAC+USC Medical Center**

Astorga, Miguel A.

Bowman, Helen M.\*

Childs, Martha R.

Evans, Evelyn M.

Flores, Eugenia E..

Haig, Pierre V.\*

Jones, Essie M.\*

Jones, Lois S.

Moore, Ernest A.

O'Connor, Vera M.

Padilla, Leopoldo A.\*

Patton, Frances L.\*

Powell, Sears R.\*

Prusek, Rolland E.\*

Richardson, Betty A.\*

Roberson, Julia

Ross, Sara V.\*

Sanchez, Henry S.

Shack, Sonora

Skidmore, Peggy A.

Thlu, Wong G.

Turner, Gladys S.

Velarde, Pauline N.\*

### **Long Beach General Hospital**

Farrell, Harold E.\*

### **Mechanical**

Fenner, Clifford C.\*

Gaddis, Walter C.

Gregory, Floyd A.\*

Lish, Verl R.\*

Ogawa, Kiyoko\*

Stanbery, Dallas S.

Welch, Elizabeth J.\*

### **Medical Support Services**

Gutierrez, Mike M.

Hong, Jerry R.\*

### **Mental Health**

Hernandez, Beatriz

### **Metro So CHC Health Center**

Evans, Dorothy R.

Walton, Jonaas

### **Municipal Court**

Bastian, Mary E.\* (Culver)

Brooks, Peggy E.\* (East L.A.)

Evans, Judy L. (Los Angeles)

Larue, Leo V. (Citrus)

Morgan, Elizabeth H.\* (Inglewood)

Schacter, David M. (Santa Monica)

Sommers, Louis\*

Sundmacher, June E. (Burbank)

### **Northeast CHC Health Svcs.**

Demirian, Hrant

Do, Chuc H.

Rivadeneira, Lourdes

Smith, Bessie

### **Olive View Hospital**

Daniels, Lucy

Feinberg, Milton\*

McVicker, Joy\*

Sandor, Helen A.\*

### **Parks & Recreation**

Castillo, Francisco\*

Deason, John D.\*

Diaz, Fermin S.\*

Gore, Robert V.

Masters, Henry L.

Moreno, Reynold P.

# IN MEMORIAM

*This list includes retired employees, both RELAC members and non-members.  
\* denotes RELAC members*

## Plant Management

Brown, Martin J.  
Denton, Perry C.\*  
Ginsburg, Daniel\*  
Orr, William  
Rivers, Ricardo  
Yerger, Alma

## Probation

Barksdale, Charlton\*  
Brown, Rudolph  
Bush, Richard A.\*  
Cobbs, Prince R.\*  
Cooper, Obie C.\*  
Crane, Joyce  
Czajkowski, Ginger S.\*  
Fischer, Lawrence H.\*  
Huff Jr., Grover C.  
Jackson, Reather  
Kaslow, Audrey A.\*  
Lewis, James E.  
Lispi, Robert  
Perez, Manuel  
Peterson, Virginia M.  
Sarchett, John\*  
Segal, Dorothy M.\*  
Shepard, Paul E.  
Steiner, Joel\*  
Taki, Keiji\*  
Thomas, Herman E.\*  
Whitcomb, William E.  
Williams, Johnnie B.

## Psychiatric Hospital

Murray, Rosa B.  
Reed, Thursie M.

## Public Health Program

Brown, Oliver  
Gutierrez, Gayle  
Leos, Joe N.  
Medrano, Eugene  
McDougall, William D.  
Perkins, Sadie B.\*  
Wiggin, Theresa  
Woods, Winifred

## Public Library

Bjornstad, Agnes E.\*  
Millett, Clara H.\*

## Public Social Services

Bauman, Mary H.\*  
Berwanger, Agatha M.  
Boyer, Melvin L.  
Carlin, Lawrence  
Doring, Claudette L.  
Friend, George  
Hall, Herbert C.  
Hawkins, Estelle

Isobe, Adoree S.\*  
Kramer, Tomasa\*  
Leyva, Sergio  
Lowe, Shelby C.\*  
Martin, Evalyn M.  
Martinez, Viola M.\*  
Maxey, Rosemary A.\*  
Murphy, Alma L.  
Murray, Lena P.\*  
Nakama, Jiei\*  
Peterson, William A.  
Rainey, Ernestine S.  
Rochon, La Verne F.  
Rostholder, Marilyn  
Siriboe, Comfort B.  
Springer, Harriette  
Valverde, Luis  
Wagstaff, Antoinette M.\*  
Weiss, William S.  
Wheaton, Marshall B.  
Whitney, Margaret B.  
Williams, Rita M.  
Wimberly, Laverne  
Worster, Elva M.\*

## Public Works

Heggie, George\*  
Henderson, Carver W.  
Lopez, Manuel  
Mc Coy, Jerry K.  
Wilson, Eugene K.\*  
Yingling, Bruce O.

## Rancho Los Amigos Hospital

Alen-Nelson, Mary E.\*  
Heard, Helen\*  
Jones, Betty J.\*  
Larrabide, John F.\*  
Lescano, Graciela  
Machelski, Gloria\*  
Ozbun, Elsie V.  
Patton, Charlotte A.\*  
Riley, Florence D.\*  
Simmons, Joyce M.  
Swallow, Elizabeth B.\*  
Walter, Katharine M.  
Winfrey, Georgia M.

## Regional Planning

Eden, David  
Malcomb, Betty B.\*

## Road

Harris, James V.

## Sheriff

Bennett, George R.  
Christenson, James O.  
Contreras, Norma T.  
De Greave, George\*

De La Piedra, Xavier B.  
Dixon, Thomas R.\*  
Ellis, Thomas M.  
Farnsworth, Lawrence N.  
Flowers, Willie B.  
Fynan, Sally J.\*  
Gilman, Rollin D.  
Harmon, James D.\*  
Holtzendorff, Dave E.  
Jackson, Cora L.  
Jeanson, Richard W.  
Johnson, Thomas L.\*  
Kynell, Henrietta\*  
Lee Jr., Jim  
Lemon, Richard B.  
Lindenmayer, Gary D.  
Mahoney, William B.\*  
Magsombol, Virgilio C.  
Morris, Bill T.\*  
Napier, Cyrus\*  
Palmieri, Gregory J.  
Panter, Lois\*  
Rakus, William E.\*  
Rawlings, Michael A.\*  
Ray, Robert L.\*  
Reutter, Pamela H.  
Roberts, Randall A.  
Ross, Willie S.  
Rottler, Charlene M.  
Stemrich, Fred E.\*  
Vallozzi, Leandro  
Walker, James W.\*  
Wright, Mary L.\*

## So. Coast Air Quality Mgmt.

Fisher, Robert  
Mayrsohn, Henry\*

## Superintendent of Schools

Laman, Donelda M.\*

## Superior Court Officers

Warren, Virginia H.  
Wilson, Terry D.  
Witucki, Mary L.  
Wong, Betty W.

## Treasurer & Tax Collector

Morgan, Gloria D.  
Nassau, Selby\*  
Williams, Ida M.\*

## Department Not Designated

Cytron, Elinore D.  
Greer, George W.  
Knecht, Elsie D.\*  
Prieditis, George  
Weidemann, Billy J.  
Williams, Rita M.

# General Membership Meeting

George Hernandez, Chair, Program Committee



**Tuesday, June 15, 2010**

**Elks Lodge 2190**

20925 Osborne Street, Canoga Park, CA 91304

~ DOOR PRIZES ~

9:00 a.m. – The Music Man

9:15 a.m. – Complimentary Refreshments

10:00 a.m. – Meeting Begins

You will need your RELAC Membership Card.

**Featured Speaker**  
**Dr. Arnold Bresky**

## **TOPIC: "Tune Up Your Brain, Tune Up Your Life"**

Dr. Bresky, known as "The Brain Tune-up Doctor", has developed a brain exercise program designed to teach us how to grow new brain cells and build cognitive reserve at any age --even in our 90's!

Retiree Information from LACERA & RELAC

### **DRIVING DIRECTIONS:**

From the westbound 118 Fwy  
Exit DeSoto, Turn left to Osborne St. –  
Turn right on Osborne.

From eastbound 118 Fwy  
Exit DeSoto, turn Right to Osborne,  
turn right on Osborne.

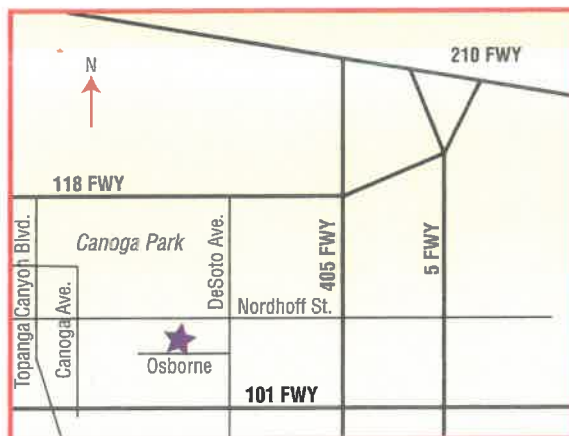

### **IMPORTANT!**

Are you moving?  
Did you change your  
name?

Cut out the address  
portion of this  
newsletter, correct it  
and mail to:

RELAC

1000 S. Fremont Ave.,  
Unit 15 Alhambra, CA  
91803-8802 or

Phone:

(800) 537-3522

(626) 308-0532

Fax: (626) 308-2901

Email:

admin@relac.org

website:

www.relac.org

Note: It is important  
that you mail this to  
RELAC or contact  
RELAC by phone  
as we DO NOT  
receive your address  
change from  
LACERA.



RETIRED EMPLOYEES  
of LOS ANGELES COUNTY  
1000 South Fremont Ave. Unit 15  
Alhambra, CA 91803-8802

Return Service Requested

NON-PROFIT  
U.S. POSTAGE  
**PAID**  
PERMIT #66  
PASADENA, CA